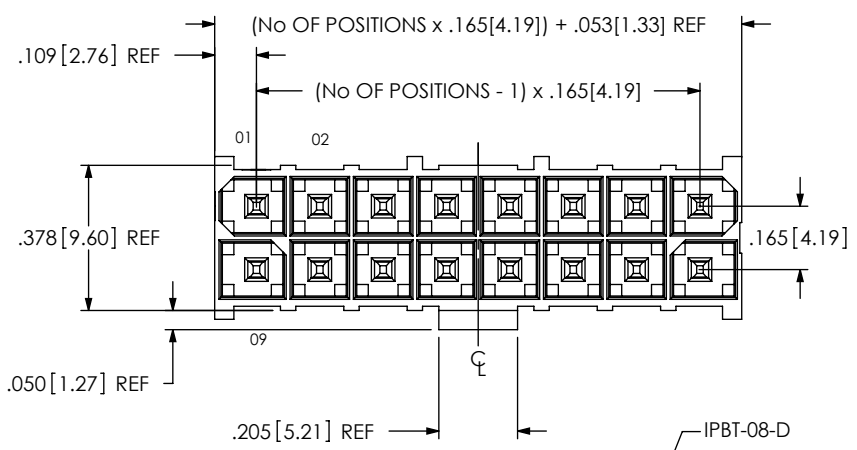

FIG. 1  
(IPBT-108-HT-XX-D SHOWN)

IPBT-1XX-XX-XX-D-XX

DO NOT SCALE FROM THIS PRINT



- No OF POSITIONS**  
-02 THRU -15 (PER ROW)  
-02 (SEE SHEET 5, FIG.8)
- OPTION**  
-RA: RIGHT ANGLE (SEE FIG. 2, SHEET 2) [STYLE -H1 ONLY]  
-GP: GUIDE POSTS (USE IPBT-XX-D-GP, SEE FIG. 4, SHEET 3)
- LEAD STYLE**  
-H1: HIGH POWER, THRU HOLE (USE T-1S55-XX-X-2, SEE FIG.1, SHEET 1)  
-H2: HIGH POWER, SURFACE MOUNT (USE T-1S55-02-X-2, SEE FIG.3, SHEET 3)  
-H3: HIGH POWER, THRU HOLE, .670" STACKER (USE T-1S55-05-X-2, SEE FIG.5, SHEET 4)  
-H4: HIGH POWER, THRU HOLE, .748" STACKER (USE T-1S55-06-X-2, SEE FIG.6, SHEET 4)  
-H5: HIGH POWER, THRU HOLE, .787" STACKER (USE T-1S55-07-X-2, SEE FIG.6, SHEET 4)  
-H6: HIGH POWER, THRU HOLE, .984" STACKER (USE T-1S55-08-X-2, SEE FIG.6, SHEET 4)
- ROW SPECIFICATION**  
-D: DOUBLE (USE IPBT-XX-D)
- PLATING SPECIFICATION**  
-T: MATTE TIN CONTACT AND TAIL (USE T-1S55-XX-T-2)  
-TM: MATTE TIN CONTACT AND TAIL (USE T-1S55-XX-T-2)

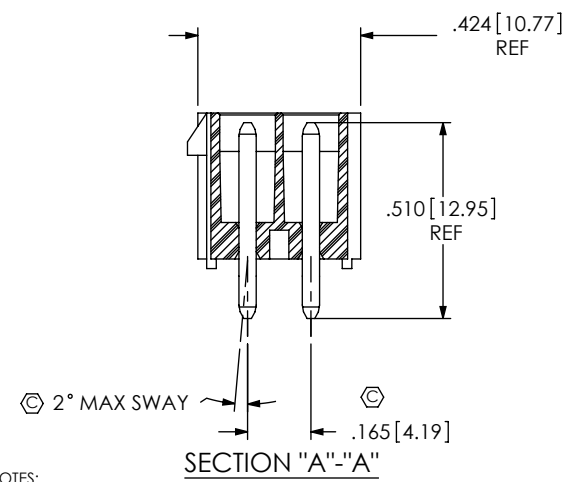
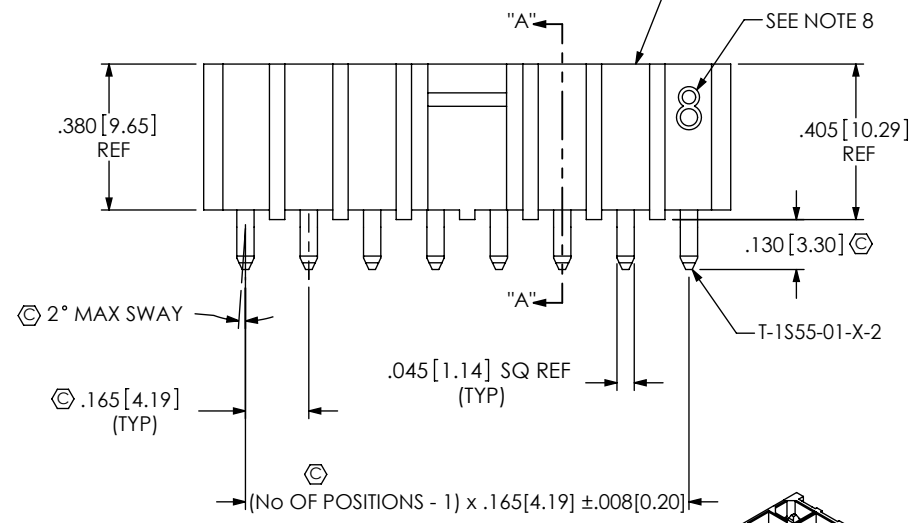

- NOTES:**
1.  $\text{⊕}$  REPRESENTS A CRITICAL DIMENSION.
  2. COPLANARITY (FOR SURFACE MOUNT): SEE TABLE 2 SHEET 3.
  3. MAX BURR ALLOWANCE: .0015 [.038]
  4. MINIMUM TERMINAL RETENTION: 1 LB.
  5. IPBT-XX-D-XX AND IPBV-XX-D PARTS TO BE MOLDED TO POSITION, IPBE-XX-XX-D ARE TO BE CUT.
  6. MAX HEIGHT VARIATION BETWEEN PINS: .005 [.13]
  7. ALL PIN TO PIN DIMENSIONS TO BE MEASURED FROM TIP TO TIP.
  8. THIS NUMBER REPRESENTS THE NUMBER OF POSITIONS PER ROW ONLY AND IS NOT INTENDED TO BE USED IN POSITION NUMBERING.
  9. ALL PARTS TO BE PACKAGED IN TUBES EXCEPT 2 AND 3 POS. 2 AND 3 POS PARTS TO BE LAYER PACKAGED.
  10. MAX CUT FLASH: .005 [.13]
  11. AFTER REVISION T OF COMPONENT PRINT IPT1-XX-D-XX-X, SAMTEC LOGO TO APPEAR ON CORE #1 FOR POSITIONS 1 THROUGH 5. FOR POSITIONS 6 THROUGH 15, LOGO TO APPEAR ON CORE #1 AND THE LAST CORE WITHIN THE SAME ROW.

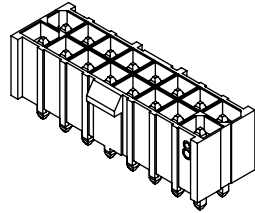

TABLE 1

LEAD STYLE	BODY 1	BODY 2	TERMINAL 1	OAL REF	TERMINAL 2	OAL REF
-H1	IPBT-XX-D	N/A	T-1S55-01-X-2	5100	N/A	N/A
-H2	IPBT-XX-D	N/A	T-1S55-02-X-2	6071	N/A	N/A
-H1-RA	IPBT-XX-D	N/A	T-1S55-03-X-2	6861	T-1S55-04-X-2	1.0681
-H1-RA-GP	IPBT-XX-D-GP	N/A	T-1S55-03-X-2	6861	T-1S55-04-X-2	1.0681
-H1-GP	IPBT-XX-D-GP	N/A	T-1S55-01-X-2	5100	N/A	N/A
-H3-GP	IPBT-XX-D-GP	IPBV-XX-D	T-1S55-05-X-2	5790	N/A	N/A
-H4-GP	IPBT-XX-D-GP	CUT FROM IPBE-31-H4-D	T-1S55-06-X-2	6580	N/A	N/A
-H5-GP	IPBT-XX-D-GP	CUT FROM IPBE-31-H5-D	T-1S55-07-X-2	6970	N/A	N/A
-H6-GP	IPBT-XX-D-GP	CUT FROM IPBE-31-H6-D	T-1S55-08-X-2	8940	N/A	N/A
-H3	IPBT-XX-D	IPBV-XX-D	T-1S55-05-X-2	5790	N/A	N/A
-H4	IPBT-XX-D	CUT FROM IPBE-31-H4-D	T-1S55-06-X-2	6580	N/A	N/A
-H5	IPBT-XX-D	CUT FROM IPBE-31-H5-D	T-1S55-07-X-2	6970	N/A	N/A
-H6	IPBT-XX-D	CUT FROM IPBE-31-H6-D	T-1S55-08-X-2	8940	N/A	N/A

UNLESS OTHERWISE SPECIFIED, DIMENSIONS ARE IN INCHES. TOLERANCES ARE:  
DECIMALS .XX: ±.01 [.3]  
.XXX: ±.005 [.13]  
.XXXX: ±.0020 [.051]

**PROPRIETARY NOTE**  
THIS DOCUMENT CONTAINS INFORMATION CONFIDENTIAL AND PROPRIETARY TO SAMTEC, INC. AND SHALL NOT BE REPRODUCED OR TRANSFERRED TO OTHER DOCUMENTS OR DISCLOSED TO OTHERS OR USED FOR ANY PURPOSE OTHER THAN THAT WHICH IT WAS OBTAINED WITHOUT THE EXPRESSED WRITTEN CONSENT OF SAMTEC, INC.



520 PARK EAST BLVD, NEW ALBANY, IN 47150  
PHONE: 812-944-6733 FAX: 812-948-5047  
e-Mail: info@SAMTEC.com code: 55322

**MATERIAL:** DO NOT SCALE DRAWING SHEET SCALE: 2:1  
INSULATOR: LCP UL 94 VO, COLOR: BLACK  
TERMINAL: HIGH COPPER ALLOY

DESCRIPTION: .165 DOUBLE ROW TERMINAL ASSEMBLY

DWG. NO. IPBT-1XX-XX-XX-D-XX

BY: DEAN P 7/27/2001 SHEET 1 OF 5

-RA: RIGHT ANGLE IN-PROCESS VIEWS

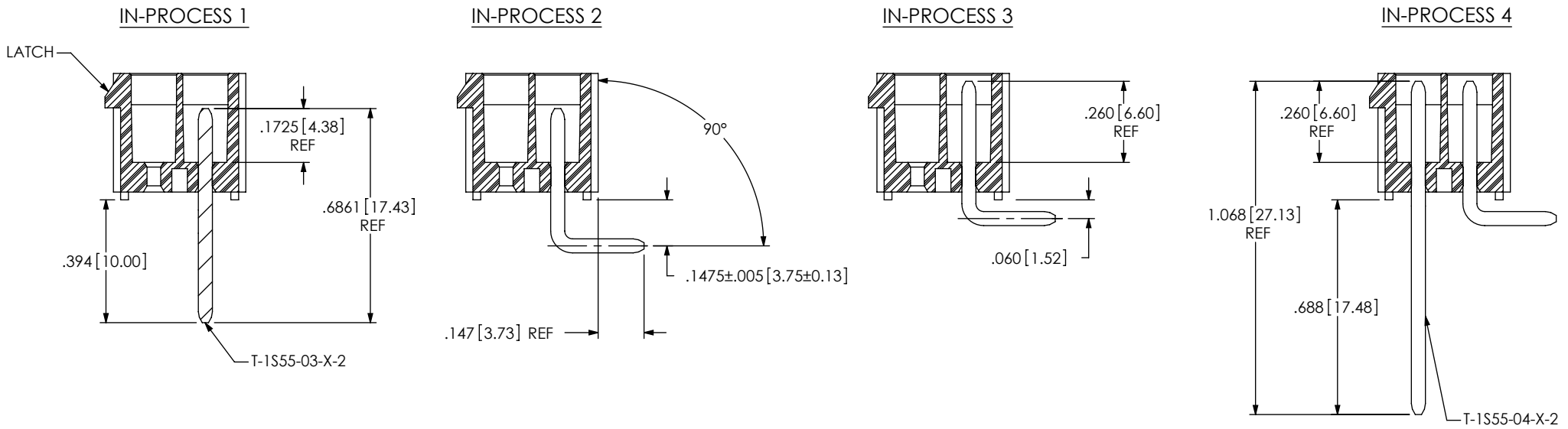
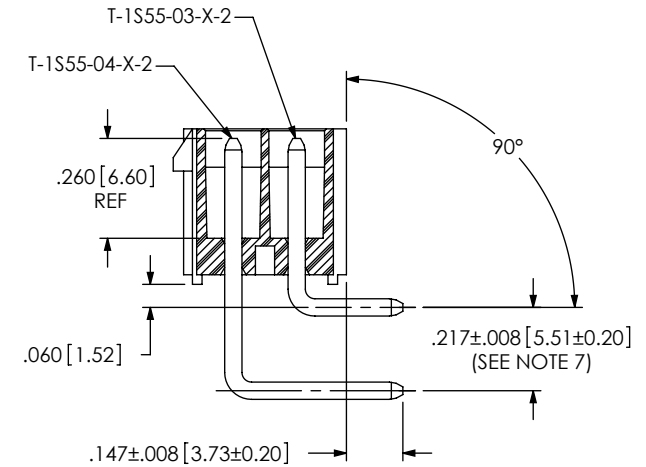
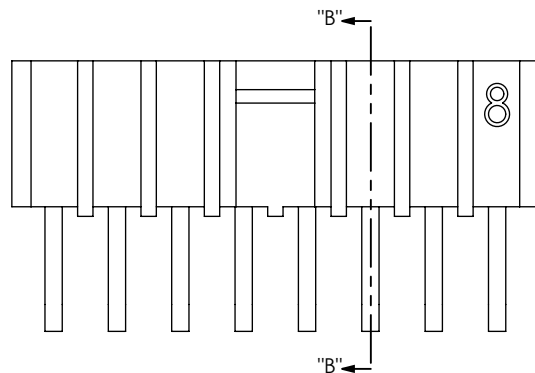
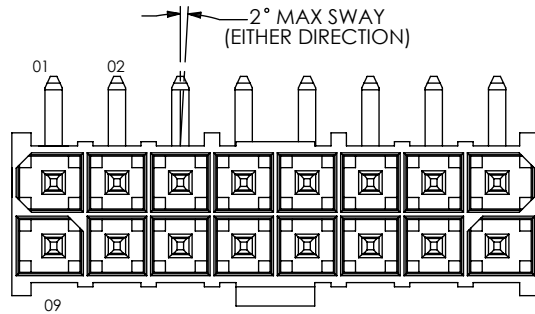

FIG. 2  
 (IPBT-108-H1-XX-D-RA SHOWN)  
 (DIFFERENT AS SHOWN, OTHERWISE SAME AS FIG. 1)  
 (AVAILABLE ONLY ON -H1)



SECTION "B"- "B"

**PROPRIETARY NOTE**  
 THIS DOCUMENT CONTAINS INFORMATION  
 CONFIDENTIAL AND PROPRIETARY TO  
 SAMTEC, INC. AND SHALL NOT BE REPRODUCED  
 OR TRANSFERRED TO OTHER DOCUMENTS OR  
 DISCLOSED TO OTHERS OR USED FOR ANY  
 PURPOSE OTHER THAN THAT WHICH IT WAS  
 OBTAINED WITHOUT THE EXPRESSED WRITTEN  
 CONSENT OF SAMTEC, INC.

DO NOT SCALE DRAWING  
 SHEET SCALE: 2:1



520 PARK EAST BLVD, NEW ALBANY, IN 47150  
 PHONE: 812-944-6733 FAX: 812-948-5047  
 e-Mail: info@SAMTEC.com code: 55322

DESCRIPTION:  
 .165 DOUBLE ROW TERMINAL ASSEMBLY

DWG. NO.  
 IPBT-1XX-XX-XX-D-XX

BY: DEAN P 7/27/2001 SHEET 2 OF 5

**FIG. 3**  
(IPBT-108-FZ-XX-D SHOWN)  
(DIFFERENT AS SHOWN, OTHERWISE SAME AS FIG. 1)

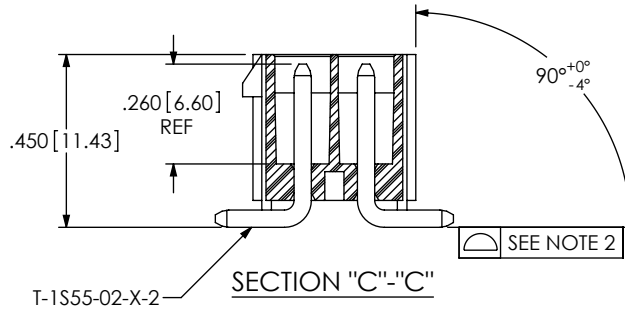
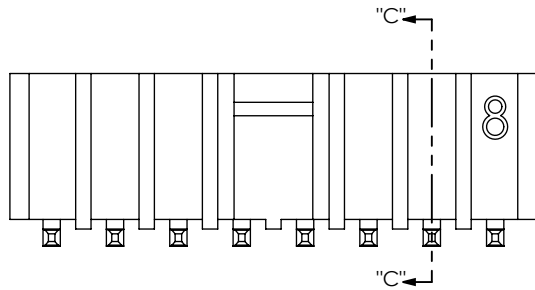
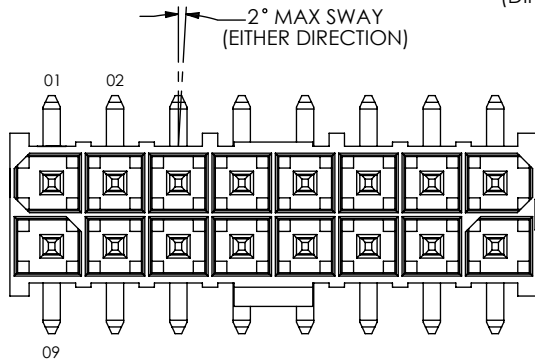
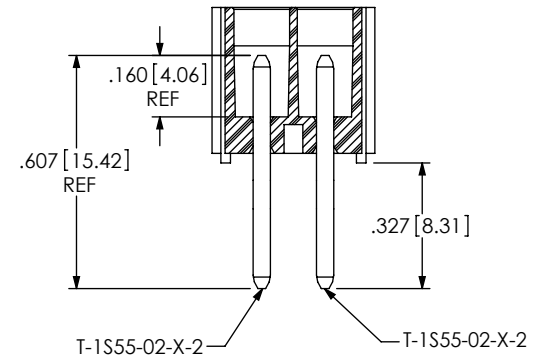

**TABLE 2**

No OF POSITIONS	COPLANARITY
-02 THRU -08	.004 [ .10]
-09 THRU -15	.006 [ .15]

H2: SURFACE MOUNT IN-PROCESS VIEWS

IN-PROCESS 1



IN-PROCESS 2

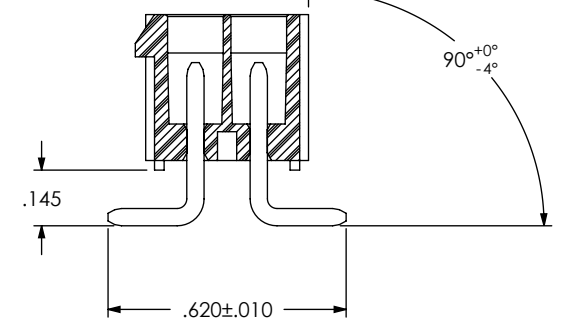

**FIG. 4**  
(IPBT-108-H1-XX-D-RA-GP SHOWN)  
(DIFFERENT AS SHOWN, OTHERWISE SAME AS FIG. 1, 2 OR 3)

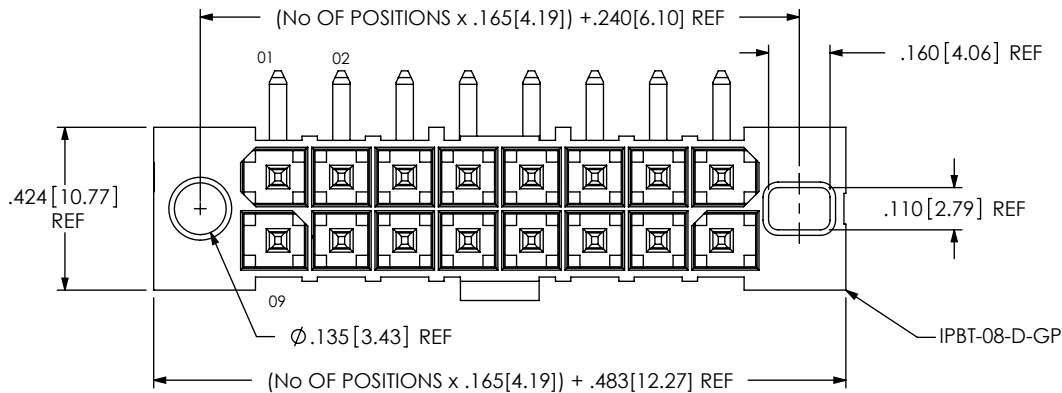

**PROPRIETARY NOTE**

THIS DOCUMENT CONTAINS INFORMATION CONFIDENTIAL AND PROPRIETARY TO SAMTEC, INC. AND SHALL NOT BE REPRODUCED OR TRANSFERRED TO OTHER DOCUMENTS OR DISCLOSED TO OTHERS OR USED FOR ANY PURPOSE OTHER THAN THAT WHICH IT WAS OBTAINED WITHOUT THE EXPRESSED WRITTEN CONSENT OF SAMTEC, INC.

DO NOT SCALE DRAWING

SHEET SCALE: 1:0.470588



520 PARK EAST BLVD, NEW ALBANY, IN 47150  
PHONE: 812-944-6733 FAX: 812-948-5047  
e-Mail: info@SAMTEC.com code: 55322

DESCRIPTION: .165 DOUBLE ROW TERMINAL ASSEMBLY

DWG. NO. IPBT-1XX-XX-XX-D-XX

BY: DEAN P 7/27/2001 SHEET 3 OF 5

REVISION U

TABLE 4		
LEADSTYLE	"C"	"D"
-H3	.579[14.71]	.094[2.40]
-H4	.658[16.71]	.173[4.39]
-H5	.697[17.70]	.212[5.38]
-H6	.894[22.71]	.409[10.39]

IN PROCESS 1  
(FOR H3, H4, H5, & H6 ONLY)

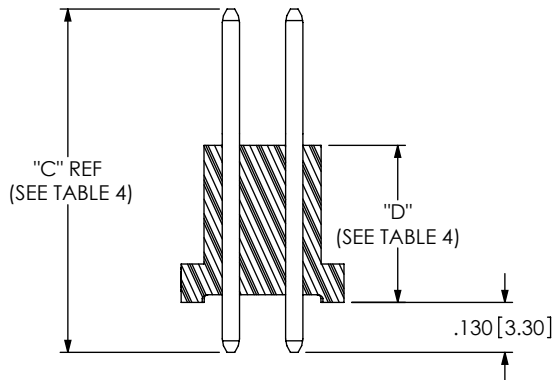

FIG. 5  
(IPBT-108-H3-XX-D SHOWN)  
(DIFFERENT AS SHOWN, OTHERWISE SAME AS FIG. 1)

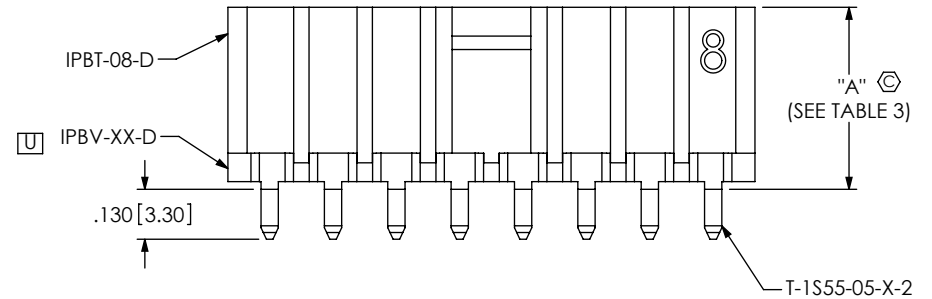

TABLE 3		
LEADSTYLE	"A"	STACK HEIGHT WITH IPBS-TH
-H3	.475[12.07]	.670[17.00]
-H4	.553[14.05]	.748[19.00]
-H5	.592[15.04]	.787[20.00]
-H6	.789[20.04]	.984[25.00]

FIG. 6  
(IPBT-108-H6-XX-D SHOWN)  
(DIFFERENT AS SHOWN, OTHERWISE SAME AS FIG. 1)

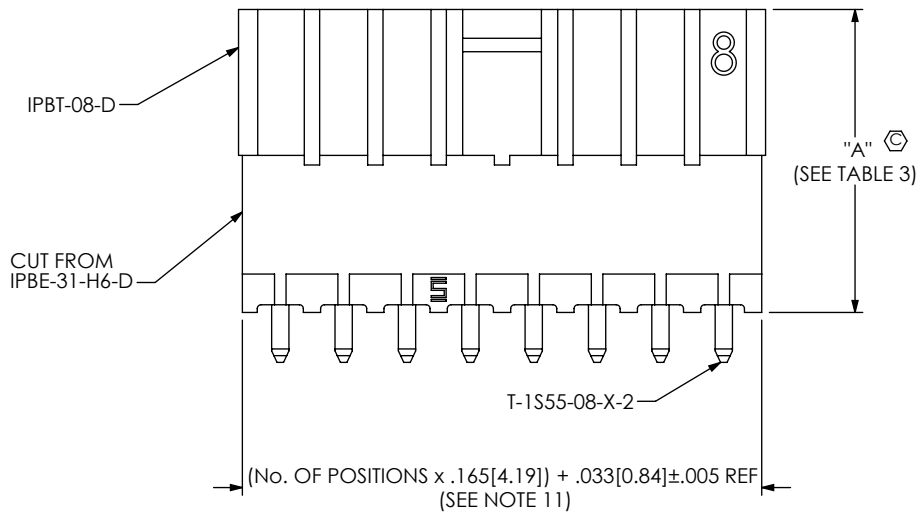
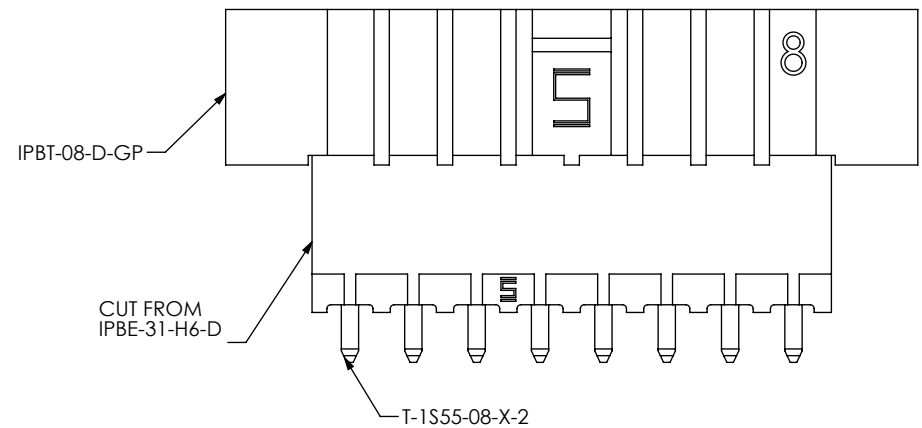

FIG. 7  
(IPBT-108-H6-XX-D-GP SHOWN)  
(DIFFERENT AS SHOWN, OTHERWISE SAME AS FIG. 1, 4, 5, OR 6)



PROPRIETARY NOTE

THIS DOCUMENT CONTAINS INFORMATION CONFIDENTIAL AND PROPRIETARY TO SAMTEC, INC. AND SHALL NOT BE REPRODUCED OR TRANSFERRED TO OTHER DOCUMENTS OR DISCLOSED TO OTHERS OR USED FOR ANY PURPOSE OTHER THAN THAT WHICH IT WAS OBTAINED WITHOUT THE EXPRESSED WRITTEN CONSENT OF SAMTEC, INC.

DO NOT SCALE DRAWING

SHEET SCALE: 2:1

**samtec**

520 PARK EAST BLVD, NEW ALBANY, IN 47150  
PHONE: 812-944-6733 FAX: 812-948-5047  
e-Mail: info@SAMTEC.com code: 55322

DESCRIPTION:  
.165 DOUBLE ROW TERMINAL ASSEMBLY

DWG. NO.  
IPBT-1XX-XX-XX-D-XX

BY: DEAN P 7/27/2001 SHEET 4 OF 5

FIG. 8  
 (IPBT-102-FT-XX-D SHOWN)  
 (DIFFERENT AS SHOWN, OTHERWISE SAME AS FIG. 1)

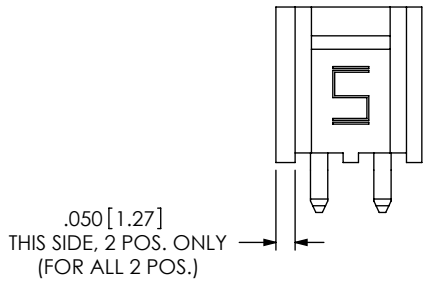

PACKAGING VIEWS  
 [PARTS TO HAVE POSITION #1 LOADED IN  
 SAME DIRECTION AS ARROW ON TUBE]  
 (SEE NOTE 10)

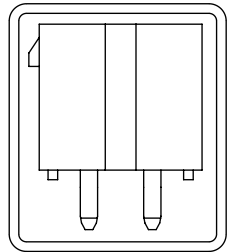

IPBT-1XX-H1-XX-D-XX SHOWN  
 TUBE: PT-1-24-01-112  
 PLUG: TP-28

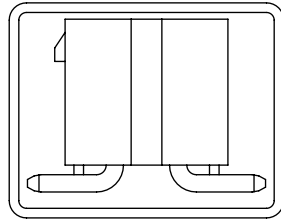

IPBT-1XX-H2-XX-D-XX SHOWN  
 TUBE: PT-1-24-02-112  
 PLUG: TP-28

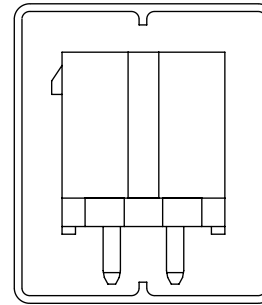

IPBT-1XX-H3-XX-D-XX SHOWN  
 TUBE: PT-1-24-04-56  
 PLUG: TP-25

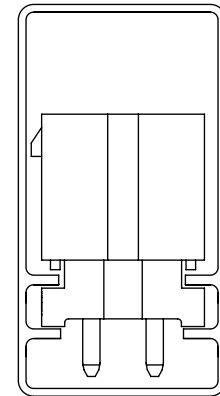

IPBT-1XX-H4-XX-D-XX SHOWN  
 TUBE: PT-IPBT001-H4-H6  
 PLUG: TP-28

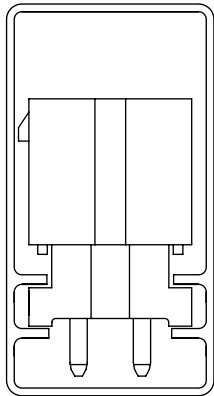

IPBT-1XX-H5-XX-D-XX SHOWN  
 TUBE: PT-IPBT001-H4-H6  
 PLUG: TP-28

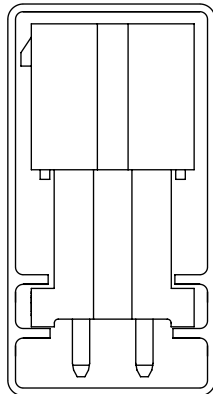

IPBT-1XX-H6-XX-D-XX SHOWN  
 TUBE: PT-IPBT001-H4-H6  
 PLUG: TP-28

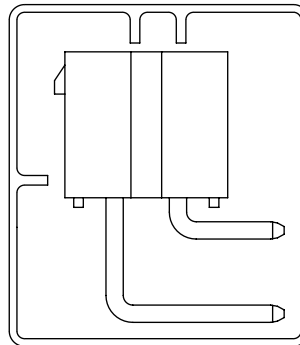

IPBT-1XX-H1-XX-D-RA SHOWN  
 TUBE: PT-1-24-05-56  
 PLUG: TP-25 (2 EACH END)

PROPRIETARY NOTE  
 THIS DOCUMENT CONTAINS INFORMATION  
 CONFIDENTIAL AND PROPRIETARY TO  
 SAMTEC, INC. AND SHALL NOT BE REPRODUCED  
 OR TRANSFERRED TO OTHER DOCUMENTS OR  
 DISCLOSED TO OTHERS OR USED FOR ANY  
 PURPOSE OTHER THAN THAT WHICH IT WAS  
 OBTAINED WITHOUT THE EXPRESSED WRITTEN  
 CONSENT OF SAMTEC, INC.

DO NOT SCALE DRAWING

SHEET SCALE: 2:1



520 PARK EAST BLVD, NEW ALBANY, IN 47150  
 PHONE: 812-944-6733 FAX: 812-948-5047  
 e-Mail: info@SAMTEC.com code: 55322

DESCRIPTION:  
 .165 DOUBLE ROW TERMINAL ASSEMBLY

DWG. NO. IPBT-1XX-XX-XX-D-XX

BY: DEAN P 7/27/2001 SHEET 5 OF 5